

LEASE PHASE AREA	COLOUR KEY	RELEASE DATE	AREA REQUIRED
PHASE 1	BLUE	MAY/SEPT 2023	TWO BLUE AREAS NORTH AND SOUTH OF KINKERDALE ROAD TOTTALLING 139,398m <sup>2</sup> (13.94 HECTARES). AREA INCLUDES LAND REQUIRED TO BUILD KINKERDALE ROAD DIVERSION. (NOTE: LAND AREA OCCUPIED BY THE NEW KINKERDALE ROAD DIVERSION TO BE EXCLUDED FOR GL LEASED LAND OR TRANSFERRED BACK TO PD PORTS AFTER CONSTRUCTION OF DIVERSION COMPLETED)
PHASE 2	GREEN	Q1 2024	GREEN AREA SOUTH OF SITE - AREA REQUIRED = 29893.77m <sup>2</sup> OR 2.989 HECTARE (WSP TO MEASURE AND INCLUDE REQUIRED AREA IN TABLE AND AMEND NOTE ON DRAWING TO REFLECT LAND TAKE SIZE) OPTION LAND AREA SUBJECT TO FINALISATION OF FEASIBILITY STUDY INTO 3 RAIL LOADING OPTIONS.
PHASE 3	PEACH	Q2 2024	PHASE 3 RELEASE SUBJECT TO COMPLETION OF ALTERNATIVE PREMISES WORK BY PD PORTS. PHASE 3 AREA TOTAL = 19400.78m <sup>2</sup> OR 1.94 HECTARES
PHASE 4	RED	Q2 2024	PHASE 4 (EXITING KINKERDALE ROAD AREA) HANDED OVER ONCE KINKERDALE ROAD DIVERSIONS WORKS COMPLETED AND ACCEPTED INTO PD PORTS CONTROL. ADOPTION/TAKEOVER TO BE SUBJECT TO COMPLETION BEING AGREED. (ISSUE OF COMPLETION CERTIFICATE NOT TO BE UNREASONABLY WITHHELD). AREA REQUIRED 5120m <sup>2</sup> OR 0.512 HECTARES

NOTES:  
 1. ALL DIMENSIONS ARE IN METRES UNLESS STATED OTHERWISE  
 2. ALL COORDINATE ARE IN METRES AND RELATE TO THE NATIONAL GRID COORDINATE SYSTEM

**LEGEND**

- SITE BOUNDARY
- PHASE 1
- PHASE 2
- PHASE 3
- PHASE 4

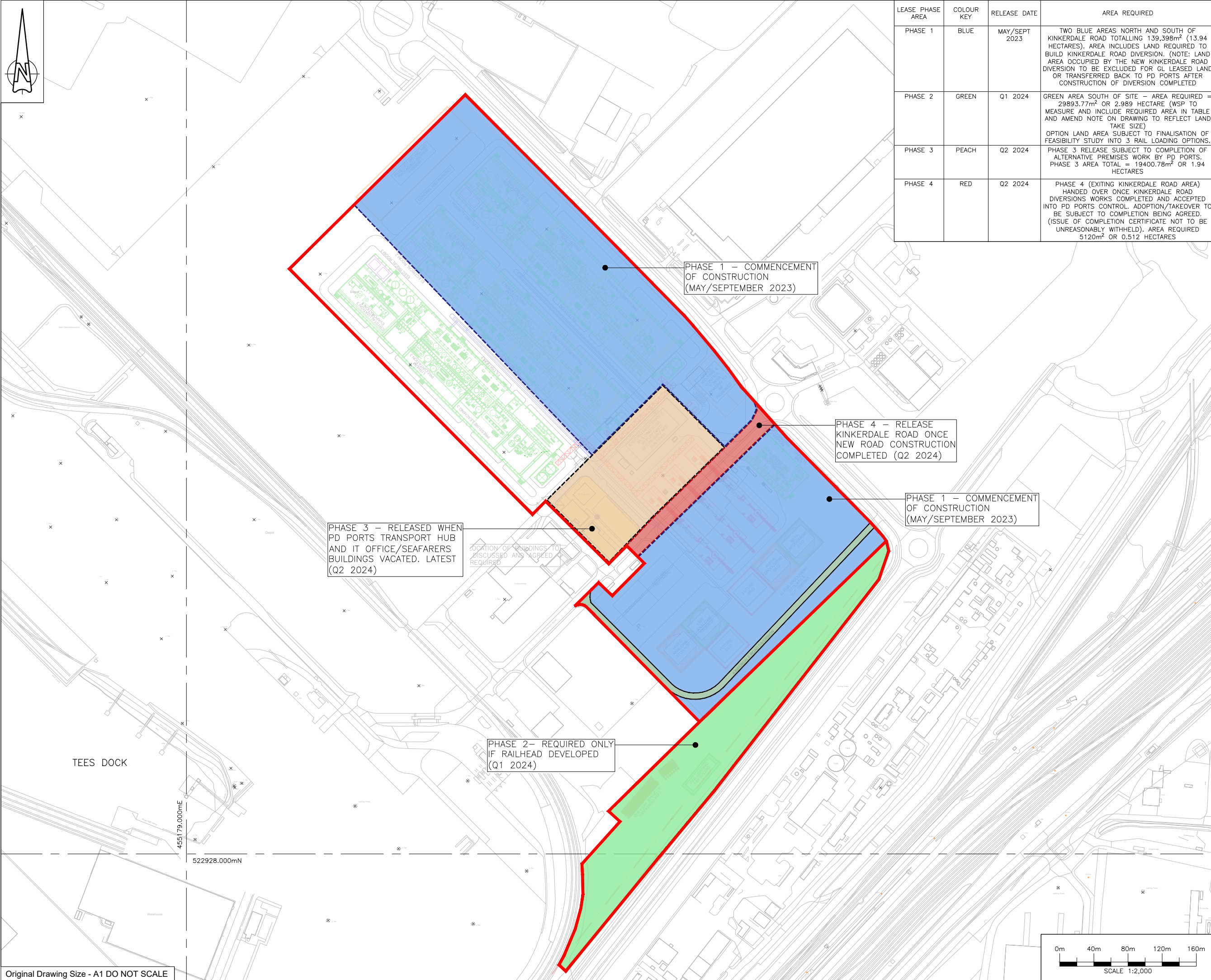

REV	DATE	DESCRIPTION	DWN	CHK	APP
P08	30/01/2023	BOUNDARY AMENDED	EDG	HM	EGA
P05	10/01/2023	BOUNDARY AMENDED	EDG	EGA	EGA
P04	07/11/2022	DRAWING TITLE AND NUMBER AMENDED	EDG	EGA	EGA
P03	02/11/2022	TABLE ADDED AND BOUNDARY AMENDED	EDG	EGA	EGA
P02	24/10/2022	DRAWING TITLE AND NUMBER AMENDED	EDG	EGA	EGA
P01	13/09/2022	FIRST ISSUE	EDG	EGA	EGA

**REVISIONS**

REV	DATE	DESCRIPTION	DWN	CHK	APP
P07	24/02/2023	BOUNDARY AMENDED	DWN	CHK	EGA

SCALES: 1:2000 @ A1

PURPOSE OF ISSUE: S2 - ISSUE FOR INFORMATION

PROJECT TITLE:  
**GREEN LITHIUM REFINERY PROJECT**

DRAWING TITLE:  
**GREEN LITHIUM GENERAL ARRANGEMENT SITE LAYOUT - PHASE 4 OPTION 1**

CLIENT:

FLOOR 3,  
 11 WESTFERRY CIRCUS,  
 LONDON,  
 E14 4HA  
 TEL: (0203) 2151610

ADVISER / CONTRACTOR DWG No:  
 807912-WOOD-XX-XX-DR-C-00010\_S2\_P07

